

Now Available

# SOL-CARE™ Safety Needle

SOL-CARE™ Safety Needles are easy to use and designed for safety to protect healthcare workers from potential needlestick injury.

## Features

- Single-handed activation
- Safety mechanism is an integrated part of the needle
- Audible "click" indicates safety activation
- Can be used with standard luer lock or slip tip syringes
- Bevel up needle allows for low angle injections
- Needle remains secure with double lock mechanism\*

### Prior to activation

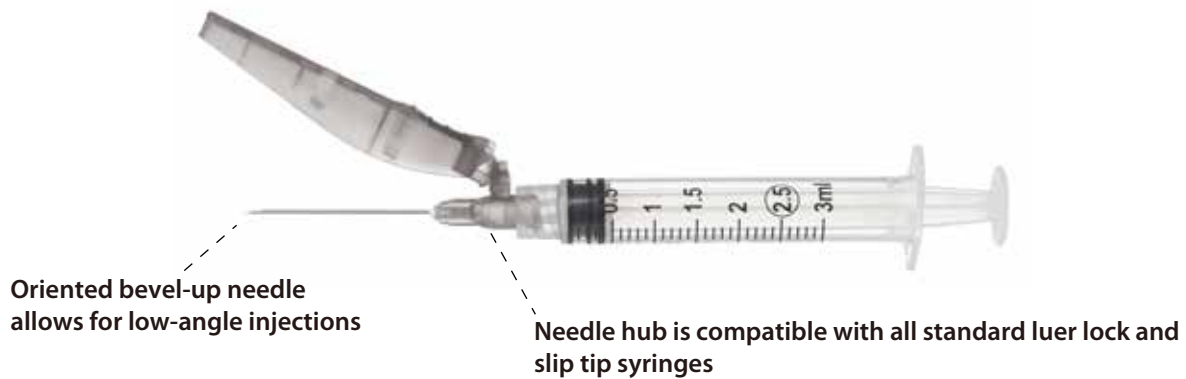

### After activation

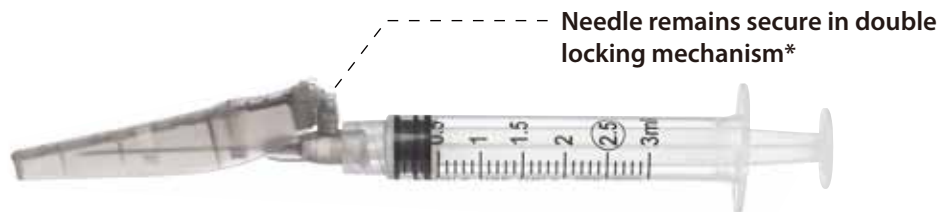

## Two Options to activate:

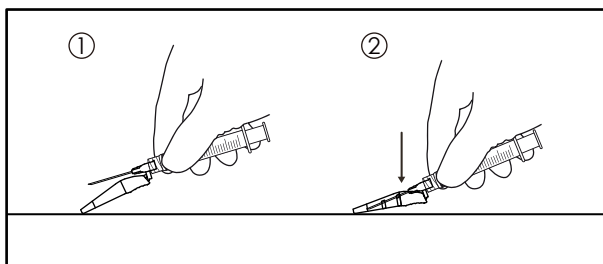

or

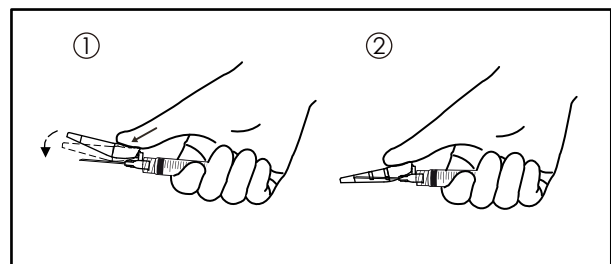

\* Patent pending

# SOL-CARE™ Safety Needle

REF	Description	Qty
<b>SOL-CARE™ Safety Needles</b>		
SN3012	30 G x 1/2 in.	100/Box; 800/Case
SN2758	27 G x 5/8 in.	100/Box; 800/Case
SN2712	27 G x 1/2 in.	100/Box; 800/Case
SN2734	27 G x 3/4 in.	100/Box; 800/Case
SN27125	27 G x 1 1/4 in.	100/Box; 800/Case
SN2638	26 G x 3/8 in.	100/Box; 800/Case
SN2612	26 G x 1/2 in.	100/Box; 800/Case
SN2558	25 G x 5/8 in.	100/Box; 800/Case
SN2510	25 G x 1 in.	100/Box; 800/Case
SN2515	25 G x 1 1/2 in.	100/Box; 800/Case
SN2310	23 G x 1 in.	100/Box; 800/Case
SN23125	23 G x 1 1/4 in.	100/Box; 800/Case
SN2315	23 G x 1 1/2 in.	100/Box; 800/Case
SN2210	22 G x 1 in.	100/Box; 800/Case
SN2215	22 G x 1 1/2 in.	100/Box; 800/Case
SN2110	21 G x 1 in.	100/Box; 800/Case
SN21125	21 G x 1 1/4 in.	100/Box; 800/Case
SN2115	21 G x 1 1/2 in.	100/Box; 800/Case
SN2010	20 G x 1 in.	100/Box; 800/Case
SN2015	20 G x 1 1/2 in.	100/Box; 800/Case
SN1910	19 G x 1 in.	100/Box; 800/Case
SN1915	19 G x 1 1/2 in.	100/Box; 800/Case
SN1810	18 G x 1 in.	100/Box; 800/Case
SN1815	18 G x 1 1/2 in.	100/Box; 800/Case
SN1820	18 G x 2 in	100/Box; 800/Case
SN2005	20 G x 2 in	100/Box; 800/Case
SN2105	21 G x 2 in	100/Box; 800/Case
SN2205	22 G x 2 in	100/Box; 800/Case

REF	Description	Qty
<b>SOL-CARE™ Safety Needles with Luer Lock Syringe</b>		
32010SN	3ml 20G x 1"	100/Box; 1200/Case
32015SN	3ml 20G x 1 1/2"	100/Box; 1200/Case
32110SN	3ml 21G x 1"	100/Box; 1200/Case
32115SN	3ml 21G x 1 1/2"	100/Box; 1200/Case
32210SN	3ml 22G x 1"	100/Box; 1200/Case
32215SN	3ml 22G x 1 1/2"	100/Box; 1200/Case
32310SN	3ml 23G x 1"	100/Box; 1200/Case
32558SN	3ml 25G x 5/8"	100/Box; 1200/Case
32510SN	3ml 25G x 1"	100/Box; 1200/Case
52010SN	5ml 20G x 1"	100/Box; 1200/Case
52015SN	5ml 20G x 1 1/2"	100/Box; 1200/Case
52110SN	5ml 21G x 1"	100/Box; 1200/Case
52115SN	5ml 21G x 1 1/2"	100/Box; 1200/Case
52210SN	5ml 22G x 1"	100/Box; 1200/Case
52215SN	5ml 22G x 1 1/2"	100/Box; 1200/Case
102010SN	10ml 20G x 1"	100/Box; 900/Case
102015SN	10ml 20G x 1 1/2"	100/Box; 900/Case
102110SN	10ml 21G x 1"	100/Box; 900/Case
102115SN	10ml 21G x 1 1/2"	100/Box; 900/Case
102210SN	10ml 22G x 1"	100/Box; 900/Case
102215SN	10ml 22G x 1 1/2"	100/Box; 900/Case



Additional sizes available upon request.

## SOL-MILLENNIUM®

### Shanghai Office:

Suite 701, Block E, 18 Dongfang Rd  
Pudong, Shanghai, China, 200120  
Tel: (86 21) 6862 2586  
Fax: (86 21) 6862 2585  
E-mail: info@sol-millennium.com

### North America Office:

5415 Sugarloaf Parkway, Suite 2203  
Lawrenceville, GA 30043  
Tel: 404.973.2200  
Fax: 404.973.2212  
E-mail: info@sol-millenniumna.com

### Europe Office:

Emilii Plater 53, PL-00113 Warszawa  
Tel: +48 22 528 69 41  
Fax: +48 22 528 67 01  
Email: info@sol-millenniumeu.com

### Australia Office:

Suite 404/8-12 Station St,  
Homebush, NSW, 2140  
Tel: 02 9746 7738  
E-mail: vera@sol-millennium.com.au

### Brasil Office:

Avenida Anhanguera, 869  
Ribeirão Preto - São Paulo, Brasil  
Tel: 14.025-480  
Telefone: 55 16 3442 1454 / 55 11 984060126  
E-mail: RBartolo@sol-millenniumbr.com